

### Features

- 25" x 22" x 8"
- 20 gauge, 304 stainless steel
- Top mount sink
- Easy-to-clean, brushed finish
- Spray insulated undercoating & sound pads
- Includes template & installation hardware
- Limited lifetime warranty
- 4-hole model available (AS110)
- ADA Compliant model available (AS110-6)

#### OPTIONAL ACCESSORY:

N/A

#### CODES:

ASME A112.19.3/CSA B45.4, cUPC



### Product Diagram

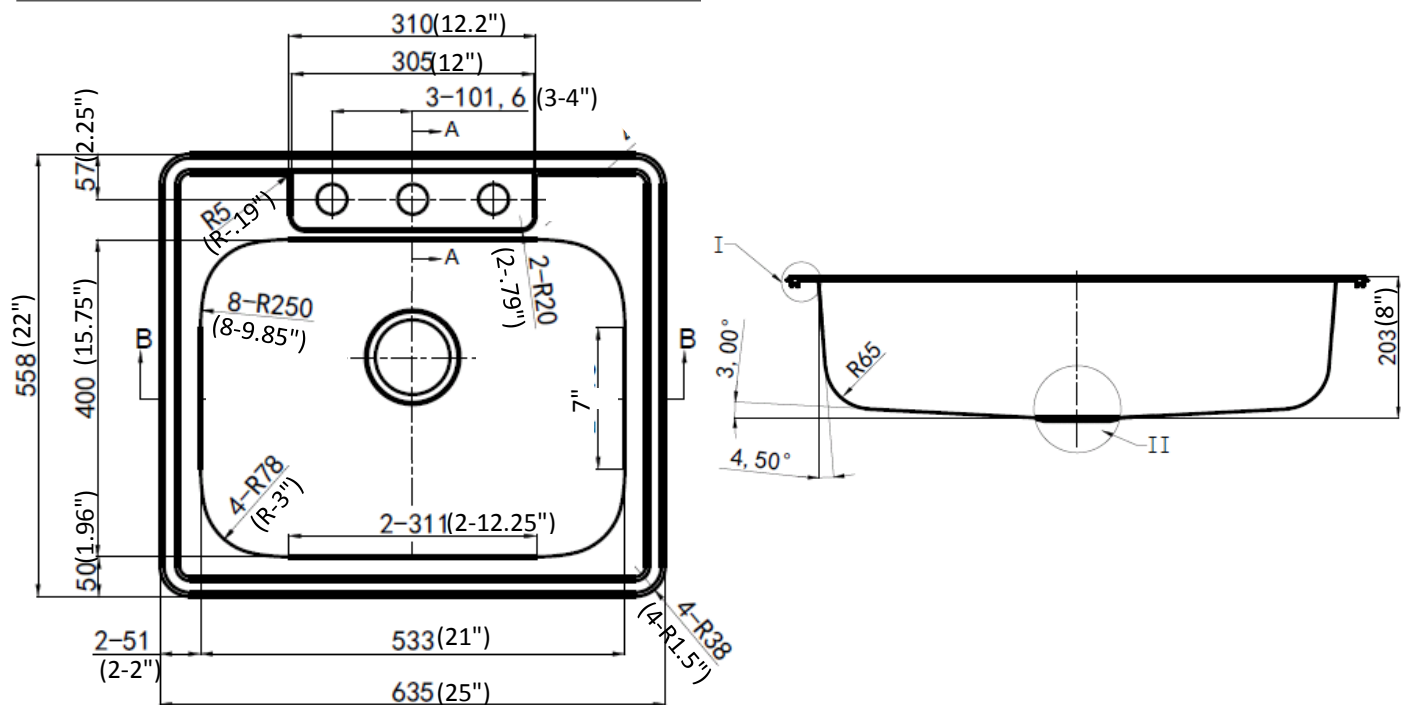

**1-877-500-SINK (7465)**

WEST COAST WAREHOUSE: 510-667-9998  EAST COAST WAREHOUSE: 404-691-5088

**WWW.AMERISINK.COM**