

### SLIDE-IN TOP MOUNT STAINLESS STEEL SINK

## AS143

#### Features

- 35.6" x 25.5" x 9.25"
- 18 gauge, 304 stainless steel
- Slide-in sink, easy installation
- No sink hole cutout needed
- Easy-to-clean, brushed finish
- Spray insulated undercoating & sound pads
- Includes template & installation hardware
- Limited lifetime warranty



#### OPTIONAL ACCESSORY:

N/A

#### CODES:

ASME A112.19.3/CSA B45.4, cUPC

#### Product Diagram

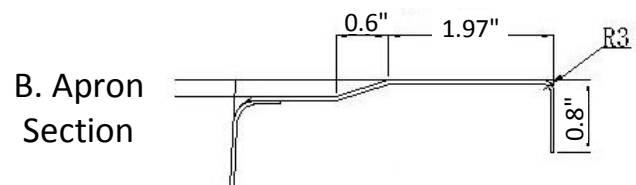
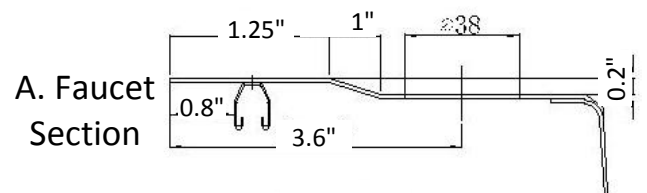
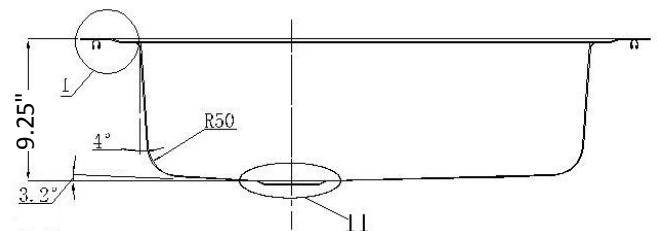
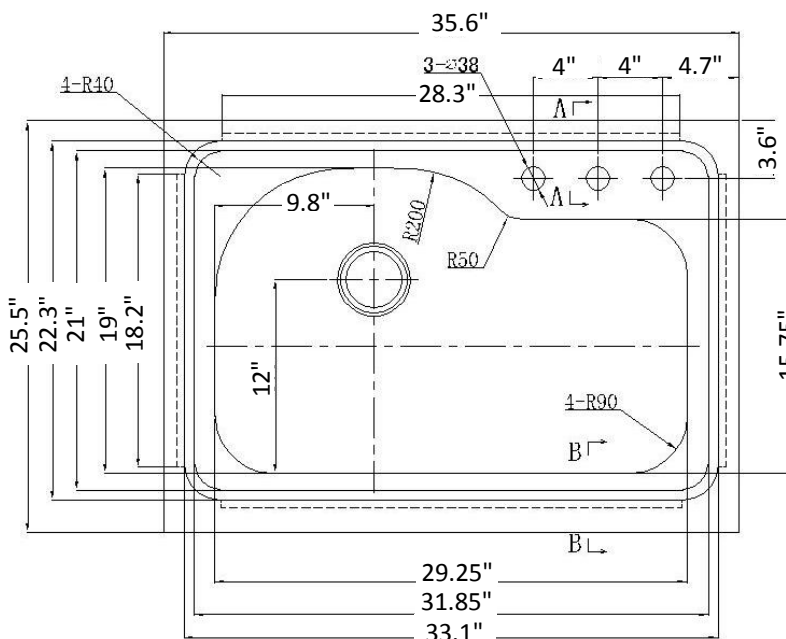

**1-877-500-SINK (7465)**

WEST COAST WAREHOUSE: 510-667-9998  EAST COAST WAREHOUSE: 404-691-5088

**WWW.AMERISINK.COM**