

# AMERISINK

## ADA COMPLIANT TOPMOUNT STAINLESS STEEL SINK AS1456

### Features

- 33" x 19" x 6"
- 20 gauge, 304 stainless steel
- Top mount sink with double track
- Easy-to-clean, brushed finish
- Spray insulated undercoating & sound pads
- Includes template & installation hardware
- Limited lifetime warranty
- 4-hole model
- ADA compliant



### CODES:

ASME A112.19.3/CSA B45.4, cUPC

### Product Diagram

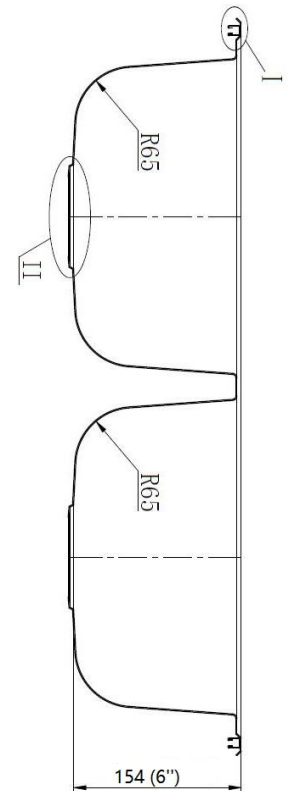
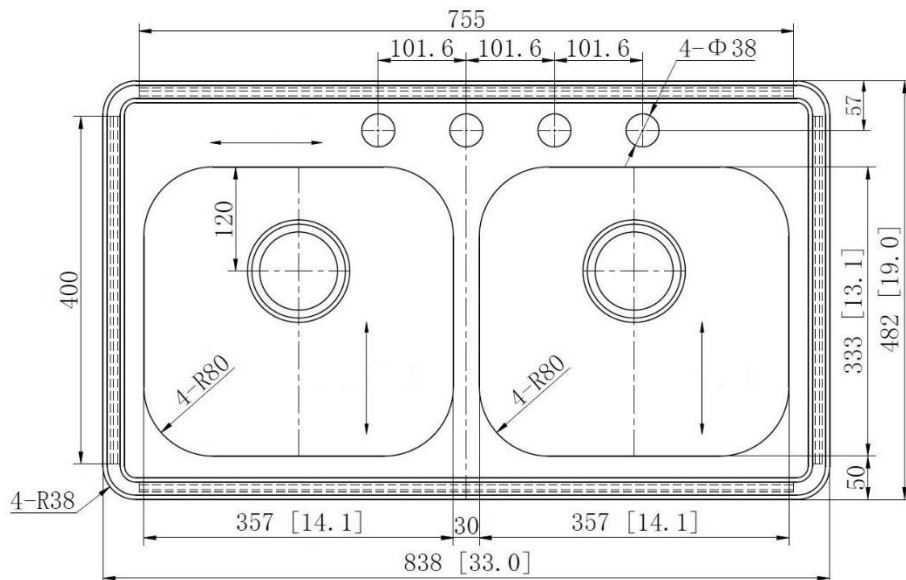

**1-877-500-SINK (7465)**

WEST COAST WAREHOUSE: 510-667-9998  EAST COAST WAREHOUSE: 404-691-5088

**WWW.AMERISINK.COM**